

Fully Insulated Female Connector

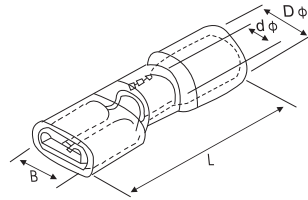

ITEM NO	Name Tab (mm)	Dimension (mm)				Description
		B	Dφ	dφ	L	
LVD 1 - 2.8F	0.5×2.8	3.2	4.0	1.7	20.0	Material: Brass Applicable Wire Range : 0.5~1.5mm ² (22~16) I _{max} =10A
LVD 1 - 2.8F(L)	0.8×2.8	3.2	4.0	1.7	20.0	
LVD 1 - 4.7F	0.5×4.75	5.6	4.0	1.7	22.0	
LVD 1 - 4.7F(L)	0.8×4.75	5.6	4.0	1.7	22.0	
LVD 1 - 6.3F	0.8×6.35	6.6	4.0	1.7	24.0	
LVD 2 - 2.8F	0.5×2.8	3.2	4.5	2.3	20.0	Material: Brass Applicable Wire Range : 1.5~2.5mm ² (16~14) I _{max} =15A
LVD 2 - 2.8F(L)	0.8×2.8	3.2	4.5	2.3	20.0	
LVD 2 - 4.7F	0.8×4.75	5.6	4.5	2.3	22.0	
LVD 2 - 4.7F(L)	0.8×4.75	5.6	4.5	2.3	22.0	
LVD 2 - 6.3F	0.8×6.35	6.6	4.5	2.3	24.0	
LVD 5 - 4.7F	0.5×4.75	5.0	5.7	3.4	23.0	Material: Brass Applicable Wire Range : 4~6mm ² (12~10) I _{max} =24A
LVD 5 - 6.3F	0.8×6.35	6.6	5.7	3.4	24.0	
LVD 5 - 7.8F	1.0×7.8	10.0	5.7	3.4	30.0	
LVD 5 - 9.4F	1.2×9.4	11.5	5.7	3.4	31.0	

Female Full Insulated Bullet Joint

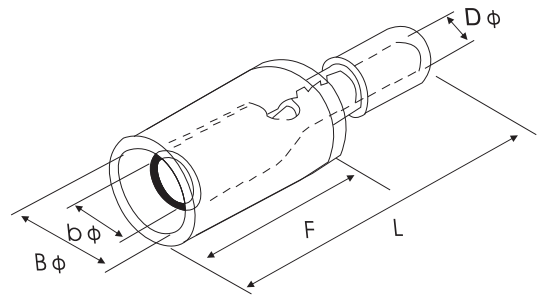
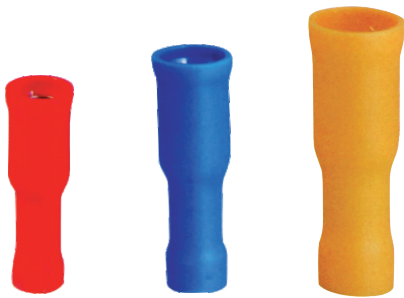

Model Number	Dimension (mm)					Description
	bφ	F	Dφ	H	L	
FIB 1.25 - 156	4.0	6.3	1.7	13.0	24.5	Material: Brass, Applicable Wire Range 0.5~1.5 mm ² AWG : 22~16, Maximum current: I _{max} = 10A
FIB 2 - 156	4.0	6.3	2.3	14.0	24.5	Material: Brass, Applicable Wire Range 1.5~2.5 mm ² AWG : 16~14, Maximum current: I _{max} = 15A
FIB 2 - 195	5.0	7.0	2.3	14.0	25.5	
FIB 5.5 - 195	5.0	7.0	3.4	14.0	29.5	Material: Brass, Applicable Wire Range 4~6 mm ² AWG : 12~10, Maximum current: I _{max} = 24A