

Fast Connecting Joints

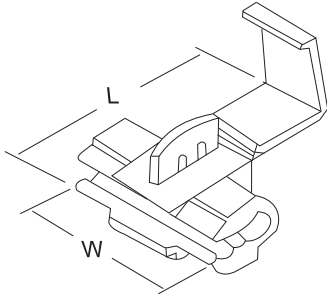

Model Number	Name Tab (mm)	Material Thickness	W (mm)	L (mm)	Ampere Rating	Description
VFJ 878100	22-18	0.5-1.0 mm ²	20.0	27.0	10 A	Max Voltage : 105.C Ui=600V Material : Copper
VFJ 878101	16-14	0.75-2.5 mm ²	20.0	27.0	15 A	
VFJ 878201	12-10	4-6 mm ²	20.5	34.5	24 A	

Long Fully Insulated Middle Joints

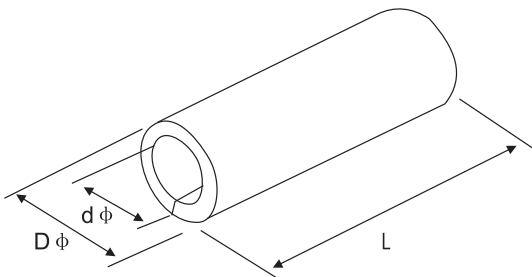

ITEM NO	A.W.G	mm ²	Dimension(mm)			I _{max}	Description
			L	dφ	Dφ		
VFMJ 1.25	22-16	0.5-1.5	27.3	1.7	3.2	19A	Max Voltage : 105°C 600V Material : Copper
VFMJ 2	16-14	1.5-2.5	27.3	2.3	3.8	27A	
VFMJ 5.5	12-10	4-6	27.3	3.4	5.3	48A	