

COPPER CABLE LUGS LONG BARREL HEAVY DUTY

MATERIAL : ELECTROLYTIC HIGH CONDUCTIVITY COPPER
FINISH : ELECTRO TINNED
FEATURES : WITH OR WITHOUT INSPECTION HOLE

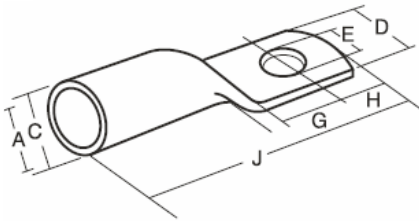

Product Ref.	Stud Hole E	Conductor Size mm ²	Dimensions mm					
			A	C	D	H	D	J
HG-CLB16:10	10.5	16	5.4	7.5	11	10	15	46
HG-CLB25:10	10.5	25	6.8	9.0	11	10	18	51
HG-CLB35:12	13	35	8.2	11.0	14	13	19	54
HG-CLB50:12	13	50	9.5	13.0	14	13	20	55
HG-CLB70:12	13	70	11.2	15.0	14	13	21	70
HG-CLB95:12	13	95	13.5	17.8	14	13	25	79
HG-CLB120:12	13	120	15.0	19.5	14	13	28	82
HG-CLB150:12	13	150	16.5	21.5	16	15	30	98
HG-CLB185:12	13	185	18.5	24.0	16	15	35	101
HG-CLB240:12	13	240	21.0	26.5	16	15	38	101
HG-CLB300:12	13	300	23.5	30.5	16	15	44	106
HG-CLB400:16	17	400	28.5	37.0	20	20	50	140
HG-CLB500:16	17	500	30.0	39.0	20	20	56	147
HG-CLB630:16	17	630	35.0	45.0	22	22	62	160
HG-CLB800:16	17	800	39.0	49.0	25	25	69.5	160
HG-CLB1200:16	18	1200	47	61	35	35	90	200

COPPER CABLE LUGS HIGH VOLTAGE-33KV LONG BARREL

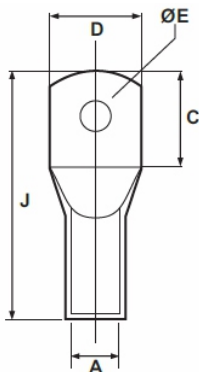

Product Ref.	Stud Hole E	Dimensions mm			
		A	C	D	J
HGHV25:8	8.5	6.8	14	17	57
HGHV25:10	10.5	6.8	17	21	61
HGHV35:10	10.5	8.2	21	26	63
HGHV35:12	13.0	8.2	21	30	68
HGHV50:10	10.5	9.5	21	26	63
HGHV50:12	13.0	9.5	21	30	68
HGHV70:10	10.5	11.2	21	28	68
HGHV70:12	13.0	11.2	28	30	72
HGHV95:12	13.0	13.5	26	30	78
HGHV95:14	15.0	13.5	29	34	81
HGHV120:12	13.0	15.0	28	32	82
HGHV120:14	15.0	15.0	31	34	84
HGHV150:12	13.0	16.5	31	34	92
HGHV150:14	15.0	16.5	32	34	98
HGHV185:14	15.0	17.0	32.5	34	98
HGHV240:12	13.0	19.2	43	34	101
HGHV240:14	15.0	19.2	43	34	101
HGHV300:12	13.0	23.5	44	34	96
HGHV300:14	15.0	23.5	44	34	102
HGHV400:14	15.0	27.0	51	41	136
HGHV400:16	17.0	27.0	51	41	140
HGHV500:16	17.0	30.0	56.5	41	147
HGHV500:20	21.0	30.0	56.5	47	153
HGHV630:16	17.0	35.0	62	41	147
HGHV630:20	21.0	35.0	62	47	159

(All Dimensions in mm)